

实验室家具及配套设施

Laboratory Furniture
& MEP System

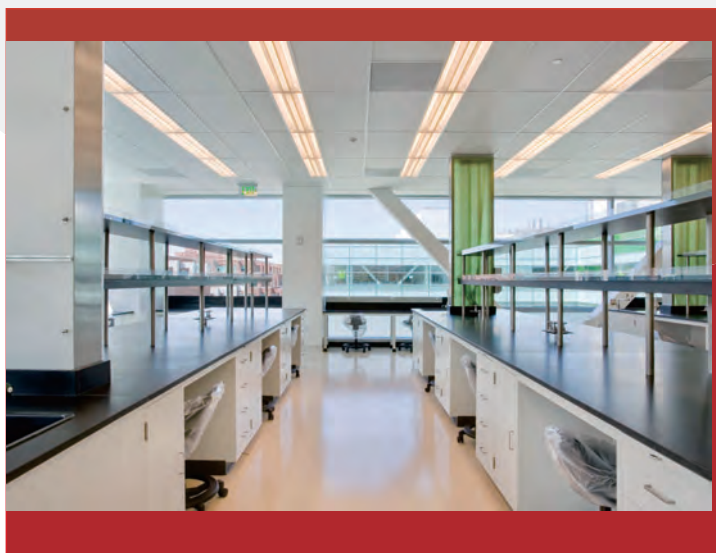

芮徕（上海）实验仪器有限公司
COVILLA TECHNOLOGY CO.,LTD

公司简介

Company Introduction

芮徕（上海）实验仪器有限公司是一家专业提供实验室设计咨询、产品生产与安装售后服务的公司。我们生产实验室家具及通风柜，代理广泛的实验室产品，拥有众多的产品组合。为我们的客户提供自实验室设计至安装调试的一站式的实验室解决方案。公司拥有一支从业超过20年的经验丰富并且才华横溢的专业团队，为我们的客户提供设计方案，成本控制，项目管理及实验室安装的一站式服务。我们承诺芮徕将为您提供最好的实验室一站式服务体验。

Covilla Technologies is focused on delivering world class laboratory products and services to our customers. Our extensive product portfolio, worldwide network and comprehensive services, enable us to offer you the best single source solution for planning, building and commissioning a fully optimized new laboratory or renovation. We have a group of professional and talented specialists who will assist you in the design, budgeting, project management and installation of laboratory with satisfying results.

We are committed to provide you the best service experience.



您的成功是我们最大的成就！



目录 Table of Contents

公司简介	
Company Introduction.	第2-3页
企业价值及资质	
Values & Qualification.	第4-5页
实验室项目完整解决方案	
Complete Solution Lab Projects.	第6-7页
实验室整体规划与设计	
Lab Overall Layout & Design.	第8-9页
实验室家具	
Lab Furniture	第10-11页
落地实验台	
Remote Leveler Access	第12页
C-Frame实验台	
C - Frame Bench	第13页
移动实验台	
Mobile Laboratory Bench	第14页
试剂架	
Reagent Rac	第15页
实验室台面	
Worktop	第16-17页
通风柜	
Fume Hood	第18页
通风柜工作原理及配套设施	
Fume Hood Working Principle	第19页
实验室配套设施	
Lab Accessories	第20页
实验室安全柜及气瓶柜	
Safety Cabinet & Gas Cabinet	第21页
实验室通风系统	
Ventilation System.	第22页
实验室局部排风设计	
Localized Extraction	第23页
实验室配气系统	
Gas System	第24-25页
实验室洁净室	
Clean Room	第26-27页
实验室家具样本	
Lab Furniture Catalog	第28-31页

企业价值及资质

Values & Qualification

协作 Collaborative

我们寻求与我们的客户实现一个共同的目标，即为他们研究和实验工作带来成功。这是一个协作的过程中，我们结合我们的知识和我们的团队来帮助客户建立实验室。同时我们的目标是结合共事的机会，在分享我们的知识的同时，也学习我们的客户和同行的实验室建设创新理念。这将给我们的客户带来更好更新的实验室。

We seek to work with our customers to achieve a common goal, their success in their research and laboratory work. This is a recursive process where we combine our knowledge and of our organizations to realize these shared goals. We aim to harness this methodology by sharing our knowledge as much as learning from our customers and peers in building consensus and innovations. This in turn will take the success of our customers to greater heights.



创新 Creative

我们相信，在创造一个世界一流的实验室时，我们需要的不完全是标准，更需要共同创新。我们可以通过创意，创新解决方案，以实现更高标准的实验室设计。通过这样的途径，我们将创建更高效率的解决方案，以满足客户的实验需求。

We believe in creating a world class laboratory not solely by standards, but together with innovation. Through creativity, we create innovative solutions to achieve higher standards of laboratory designs. While doing this, we will create high efficient solutions to meet your needs.



承诺 Committed

我们所有的努力的关键在于我们致力于为客户提供最有价值的成功。这是一个神圣的使命，因为我们寻求与所有的客户和行业合作伙伴结成长期的合作伙伴关系。

All of our efforts hinge on our highest commitment to deliver successes to our customers. This is a sacred value as we seek to forge a long term partnership with all our customers and industry partners.



协作 · 创新 · 承诺

Collaborative · Creative · Committed



芮徕承诺将通过我们不懈的创新与合作，使我们的客户满意！
We are committed to deliver success through creative innovation and solid collaboration with our customers!

实验室项目的完整解决方案

Complete Total Laboratory Projects Solutions

●全方位的能力

在全球各个角落的生产与经销的能力，配合实验室项目的经验与特长，能为您带来全方位的解决方案及服务。

●分析客户的需求

以我们国际性的经验与眼光，配合我们在每一个项目服务现场的人材与智慧，我们能为每一位客户提供仔细且符合当地需求的咨询与服务。我们和您一起分享、考较每一项设施，设想每一个方案，务必寻求最贴切及适用的设计。

●实验室的设计与工程

我们以专业的电脑绘制图纸来向客户体现我们的设计与概念。我们也以我们在国际上丰厚的经验为每一位客户提供所有关于实验室，最先进、最实用、最安全的提案与建议。这也涵盖了工程的细节，仪器的选购，耗品、试剂的供应等。

●实验室家具

向来以设计和生产最高品质的实验我们为客户提供最耐用、最符合安全与品质标准的实验室家具及通风柜等。

●物流全球通

为所有的货物提供物流保险。我们为每一项个别的项目所设的特种物流队伍确保我们能准时供货，准确交货。

●项目管理

我们为每一个大型项目设立一组项目管理组。我们有着经验丰富的现场工作人员，后勤支援人员，技术咨询人员等，以确保每一个项目能依设计指标漂亮完工。

●现场施工

我们经验丰富的现场施工队能在每一项作业上，如：空调与排风(HAVC)、管道、电路及家具等，与各有关方面有效的沟通而确保安装质量与速度。

●保修与维护

我们的项目服务队能为我们所建设的每一个实验室





一站式 实验室解决方案

专业实验室服务商
Your Laboratory • Delivered



实验室的整体规划与设计

Overall Laboratory Layout Design

1. 平面布局>>>>>

Lab Layout

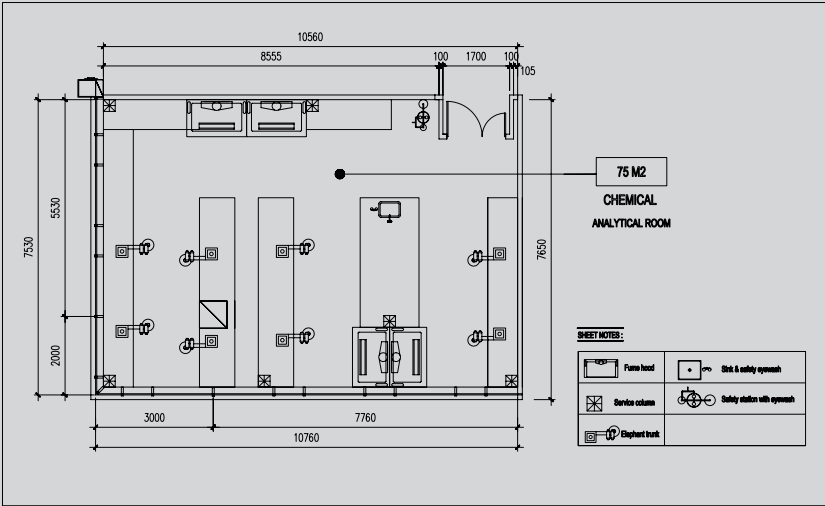

<<<<<2.立体图

3D Drawing

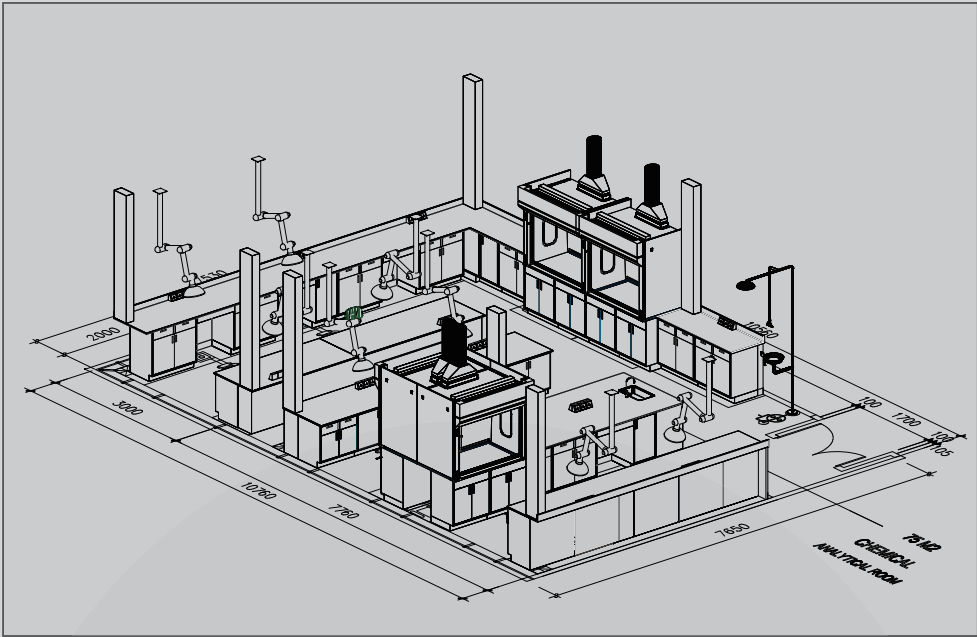

3.效果图>>>>>>>>>

Rendering



实验室的建设、无论是新建、扩建、或是改建项目、它不单纯是选购合同的仪器设备，还要综合考虑实验室的总体规划、合理布局和平面设计，以及供电、供水、供气、通风、空气净化、安全措施、环境保护等基础设施的基本条件。因此实验室的建设是一项复杂的系统工程。在现代实验室里，先进的科学仪器和优越完善的实验室是提升现代化科技水平，促进科研成果增长的必备条件。“以人为本，人与环境”已成为人们高度关注的课题。芮徕实验室本着“安全、环保、高效、耐久、美观、优质、舒适、领先”的规划设计理念。

For a laboratory project, whether new or an expansion is not a simple one time purchase as a lab equipment/instrument. It involves multiple work streams consideration when designing the overall layout plans, workflow and adjacencies, all related mechanical, electrical and plumbing supply systems, safety systems and the environmental impact considerations. These are essential to provide an ideal laboratory that will harness the intellectuals of the scientists together with the advanced instrumentations which will raise the scientific research achievements to new heights. It is essential to provide personnel oriented lab environment for our customers to attract and retain the talent of the research community. Covilla's designed and constructed laboratories upholds the essentials of safety, the environment, efficiencies, durability, aesthetics, high-quality, comfort and technological advancement of the future.

规划设计主要分为八个方面：

- 家具布局设计系统
- 设备功能设计系统
- 电气系统
- 集中供气系统
- 通风控制系统
- 空气洁净系统
- 废气废水处理系统



Designing and layout can be divided into eight major aspects:

- Laboratory functions, Work flow and adjacencies
- Equipment functions
- Laboratory furniture layout design
- Gas supply system
- Electrical system
- Air flow control system
- Heating and air-conditioning system
- Air purification system
- Waste supply and drainage system

实验室家具

Lab Furniture

实验室环境对家具选择的要求非常高。为了使其经久使用，实验室家具必须坚固耐用，具有耐强化学物质的性能，我们的全钢系列也一直是发生泼洒，腐蚀剂残留以及超负重的实验环境下的首选产品。我们为您提供多样化的产品以及众多的颜色和硬件供您选择。嵌入式全钢结构的门和抽屉都是在柜体边框的里面。外面看得到的柜子边框为柜面提供了强调色的位置。用我们多种现代工艺粉末涂层的调色板可以为您提供数百种丰富的色彩选择。

A lab is a very hostile environment for furniture. To survive and last, lab furniture has to be built tough enough to take the harsh environment of the laboratory. Highly resistant to chemicals and abuse, steel furniture has long been the product of choice in laboratory environments where spills, corrosive agents and heavy loading is common. Combining classic good looks and durability, we have developed a diverse product selection of steel components that come in a wide variety of colors and hardware options.



吊柜的选择
吊柜的选择包括前开门、拉门、铰链门，并提供有框玻璃和无框玻璃两种样式

Wall Cabinet Options
Wall cabinet options include open fronts, and sliding or hinged doors in solid panel, framed and unframed glass styles.

可调高度的隔板
柜体隔板的高度可以调节一厘米左右

Adjustable Shelf Height
Shelf height is adjustable in half-inch increments over the full height of the cabinet.

拉手的样式
标准的矩形铝制拉手。另外还有金属丝拉手和移门拉手可供选择。

Choice of Pull Styles
Rectangular brushed aluminum pulls are standard. Optional wire and flush pulls are also available.



每一个柜体的面板、挡板和外角柱都是取材于同一块一级冷轧钢板，以保证最大的强度。

Wrap around cabinet body construction

The sides, back and outside corner posts of each component are made from one sheet of cold rolled steel to which provides maximum strength and eliminates the need for an applied finished back.



自动关闭焊接式的抽屉

每次打开抽屉都可以轻松的合上，焊接式的抽屉能够支撑重负载，能够经受频繁的开与关，并且接头不易损坏，更不会碰到下面开着的门板。

Self-centering, self-closing, rise up drawer suspension

Drawers operate almost effortlessly and return to the same location every time for uniformity of reveal spaces. A lock open feature allows you to work from an open drawer with both hands free. Rise up drawer suspension prevents interference of a fully loaded drawer with an open door below.



抽屉清洁更轻松
凹槽设计让柜子的清洁更方便。

Easy to Clean Drawers

Coved horizontal corner make drawers easier to keep clean.



全不锈钢合叶及轴心，配以镀锌或不锈钢螺母，极高承重重力。

Durable Hinges

Durable corrosion resistant stainless steel hinges.



家具的喷涂工艺

家具的粉末喷涂，符合SEFA8 测试标准(SEFA推荐)，提供最可靠的抗化学腐蚀性，极耐磨损，并有多种标准色彩可供选择。

Electrostatically applied powder coating

Powder coating delivers reliable chemical and abrasion resistance and is available in your choice of colors.

落地式实验台

Floor Standing Laboratory Bench

落地式实验台简洁而牢固。底柜的存储空间可以更好的利用实验室空间。一个完整的试验台可以承重226公斤的重量。所有的线路都是实验台的后面排到底柜里。底柜和抽屉都是可以更换的。

Floor standing laboratory cabinets provide a simple yet sturdy structure. Base cabinets provide the support and storage at the same time for an efficient use of the lab space. A complete lab bench can support up to 226 kg (500 lbs). All utility supply services are tucked away behind benches accessible from access panel within each cabinet. The cabinets are built with modular concept where door panels and drawers are interchangeable.

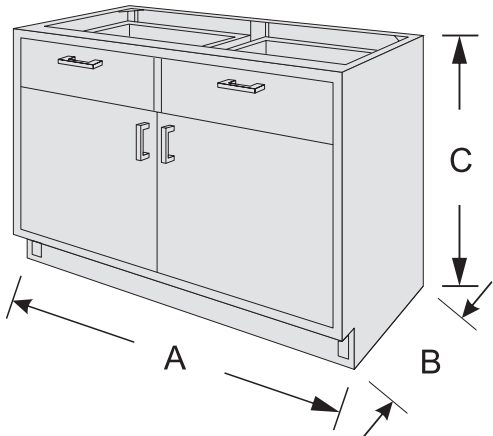
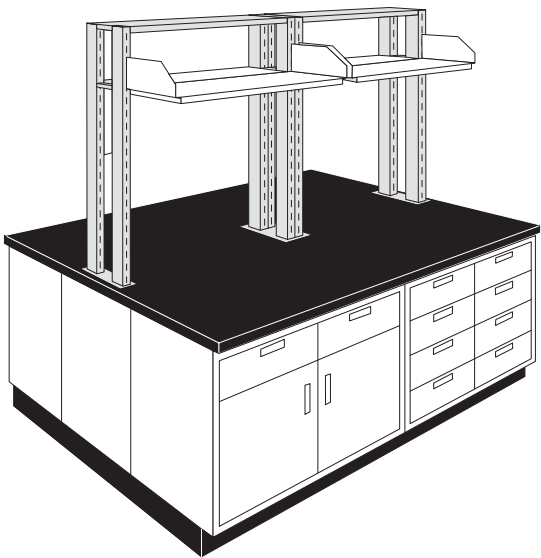

规格尺寸 (Dimensional Chart)			
A 长度 Length (mm)	B 深度 Depth(mm)	C 高度 Height(mm)	
610	549	746	895
762			
914			
1067			
1219			

C-Frame实验台

C-Frame Bench

C-frame 家具都是悬吊式的全钢结构。这些框架可以支撑整个试验台和悬挂着的储存设备。所有的支架都可以安装在不同的位置，并且都是可以调节水平高度。增加了灵活性并且和试验台的坚固性。全钢结构试验台可以更具实验室的使用需要在下面悬挂底柜。根据使用需要，底柜可以移动，增加或者移除。柜子既可以悬挂着也可以做成移动式的。试验台上的空间还可以放试剂架。

C-frame furniture system consists of free standing frame of steel channel and frame work. The frames provide support for the entire bench and suspended storage units. All leg assemblies can be installed at different length intervals with adjustable horizontal channels. This augments the flexibility and structural strength of the lab bench. The framework system provides basic bench support structure where storage spaces can be added in the future based on the lab usage requirements. Cabinet units can be moved, added or removed after installation based on the lab changing requirements. Cabinets can be either suspended on the framework or mobile cabinets can be used for maximum flexibility. Upper storage can be added using the upright reagent rack system.

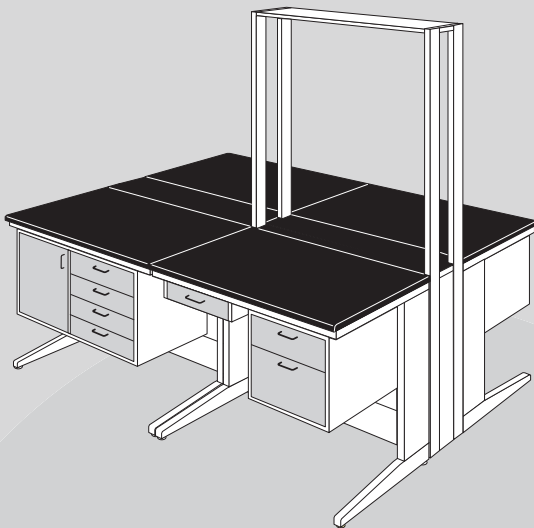

采用60*40*2mm的方钢管，强大的基础承受力。

移动式实验台

Adaptable Laboratory Bench

实验室的环境通常都很特殊，移动式家具让实验室里的仪器，器材，人员，研究活动以及室内布置更具灵活性。它包括三种，并且每个都有着独特的设计。根据需要所有的部件都可以单独分开或组装在一起，另外还有落地式橱柜可供选择。只有水槽和通风柜使用落地式橱柜。所有可移动的部件不需要很多工具即可再装。同时可以减少安装和再装的成本。所有的部件都是互相兼容的，可以一直使用。移动式家具可以减少目前或将来的工作台，房间布局或者整个实验室的改变所需要的时间，成本以及精力。

Laboratories are dynamic environments. Adaptable furniture systems are designed to adapt to change in the laboratory, adapting to changing equipment and instrumentation, personnel, research activities and room layouts. It consists of different product parts, each with unique capabilities. Components from all three systems can be used independently or integrated as needed, along with floor-mounted cabinets to provide a tailored solution for each application. Only sinks and fume hoods use floor-mounted cabinets for support. All adjustable components are designed to be easily reconfigured with minimum tools. Easy access to service lines reduces installation and reconfiguration costs. All system components are totally compatible, ensuring continuous availability. Adaptable furniture system responds to current and future change, providing the capability to change workstation configurations, room layouts or move entire laboratories as needed, with minimal downtime, cost and effort.

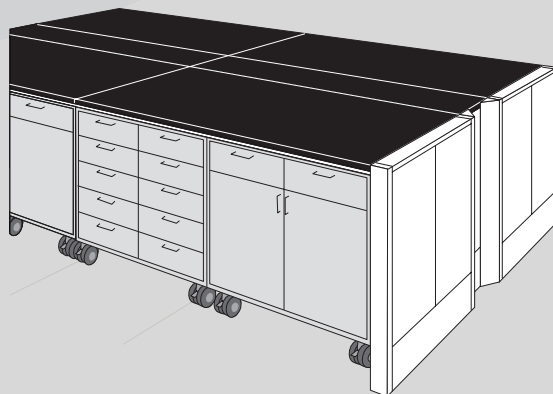
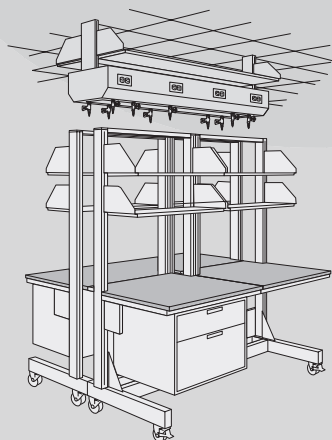

试剂架

Reagent Racks

可拓展型的试剂

可拓展型的试剂架可以最大空间的利用桌面来存放。可以固定在任何工作台并且可以与所有的移动式家具配套使用。

Upright Reagent Racks

Bench-top uprights provide maximum utilization of space above the work surface for storage. It can be bolted to any work surfaces and accommodate all Adaptable Furniture shelving and wall cases.



普通型的试剂架

普通型的试剂架可以放在水槽或坚硬的台面上。试剂架的工作台面也可以根据试验台的台面来做。另外在工作台面上还提供排气和通电，装在试剂架的前端或旁边。

Normal Reagent Racks

Standard steel racks can be used over troughs or solid surfaces. Different work surfaces can be mounted based to match the lab bench surface. It provides service utility channel for above the work surface services for gas and electrical. Utility services can be mounted on the front or side of the reagent racks.

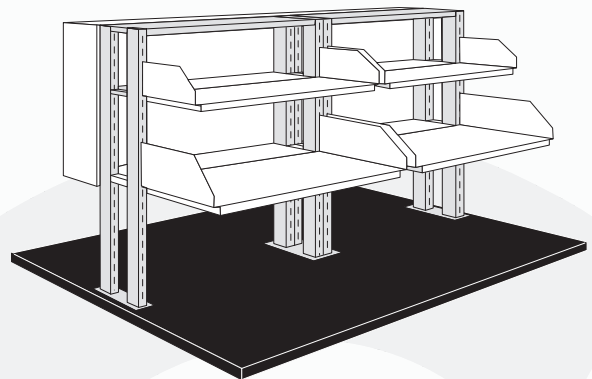
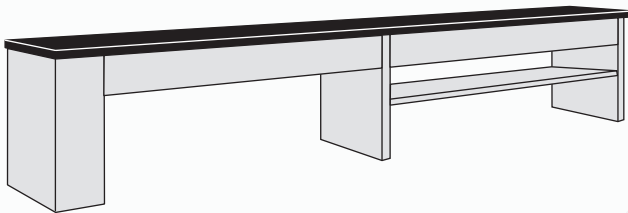

实验室家具台面

Lab Furniture Work Surfaces

对于任何一个实验室来说，工作台面的选择至关重要，我们提供了最完整的台面选择，以满足各种实验室功能的需要。经实地测量计算后，台面的制作和加工全部原厂进行，以保证品质。每一种台面都有其特性，不同的实验操作，不同的实试剂所需的台面材质都不同，我们会提供参考咨询，为您选择最适合的台面材质。

We offer a complete selection of work surfaces to meet your specific requirements for chemical, moisture, heat and impact resistance. Choose from epoxy resin, phenolic resin, chemical resistant plastic laminate, ceramics, marble/granite or stainless steel. Select from a variety of colors and edge configurations. All of our work surfaces are field measured and cut to size in the factory for quality assurance.

台面开孔>>>> Work Surface Cutouts

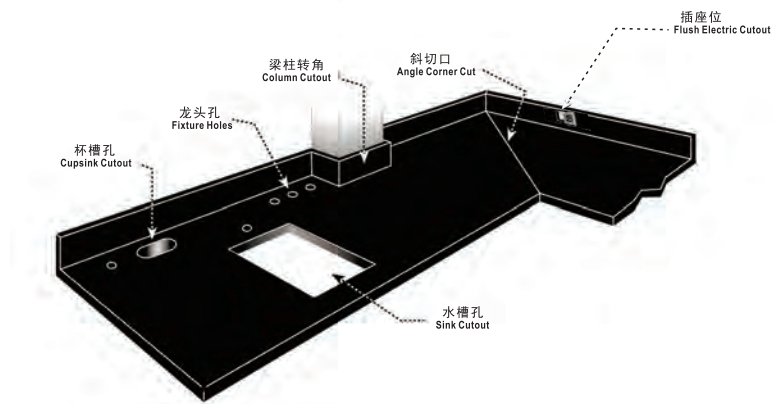

工作台面性能的部分参考指数

描述	环氧树脂	实芯理化板	陶瓷	不锈钢	大理石
抗磨损	● ●	●	● ● ●	● ● ● ●	● ● ●
防污渍	● ●	● ●	● ●	● ●	● ●
抗化学腐蚀	● ● ● ●	● ● ● ●	● ● ● ● ●	● ● ●	● ● ●
抗菌	● ● ● ●	● ●	● ● ●	● ● ● ●	● ● ● ●
耐辐射热	● ● ● ●	● ● ●	● ● ● ● ●	●	● ● ● ● ●
防潮性	● ● ● ●	● ● ●	● ● ● ●	● ● ● ● ●	● ● ● ● ●
绝缘性	绝缘	绝缘	绝缘	导电	绝缘
承载力	● ●	● ●	● ●	● ● ● ●	● ●
清洁便利	● ●	● ●	● ●	● ● ● ●	● ●
通风柜台面	适用	不适用	适用	适用	适用

不同材质的台面 Material



陶瓷板
Ceramic plate

特性：陶瓷板是具有极强的耐候性，无论日照、雨淋(甚至酸雨)，还是潮气都对表面和基材没有任何影响。耐紫外线照射和色彩稳定性完全达到国际灰度级4-5级。抗弯强度和弹性的合理组合，使陶瓷板具有很高的耐冲击强度，具有极好地耐火特性；



环氧树脂板
Epoxy resin board

特性：耐酸碱、耐高温、可打磨修复；其物理性能相对于其他面板而言更稳定。具有优良的力学性能、高介电性能、耐表面漏电、耐电弧的优良绝缘材料。具有更好的耐酸碱及高温性能，最高耐温可达600℃；



不锈钢
Stainless steel

特性：耐一定的强酸，耐刮磨，便于清洁，耐高温可达180℃；多用于油漆、染料及润滑油等行业。



实芯理化板
Solid physiochemical board

特性：理化板具有优异的耐冲击性、耐水、耐湿性、耐药性、耐热性、耐磨性，而且其耐候性也很优异。太阳光照射也不会引起变色、褪色。此外，产品难于沾上污垢，易清洗，维修保养方便。产品的寿命可持续长久，理化板的冲击吸收力以及特殊制造工艺使其具有一定威力的抗震性。



大理石
Marble

特性：刚性良好、硬度高、耐磨性强，温度变形小于便于清洁、可打磨修复，使用寿命长，不磁化；

实验室家具颜色

Color Selection Of Work Surfaces & Casework

实验室常用的颜色样式 Commonly used color

Powder Coat
粉末喷涂



Phenolic Resin
实芯理化板



Epoxy Resin
环氧树脂



通风柜

Fume Hood

我们的通风柜采用了最近的技术及创新，在性能，样式，表现上都有所提高。我们的通风柜是使用坚固的材料建造而成，并且可以应对实验室内恶劣的环境并为产品提供了极高的使用价值。

Our fume hoods incorporate the latest innovations and technology for fume hood performance features, enhancement and styling. We construct our fume hoods with durable materials and finishes specific to the harsh environment of a laboratory and is designed to provide superior value throughout the life of the product.

特点 Features:

- 移门可视高度有35英寸高 35" sash viewing height
- 组合移门 Combination sash
- 补风翼片 Low profile airfoil
- 铰链移门平衡系统 Chain drive sash counterbalance system
- 无需调整的扰流板 Preset baffle system – no adjustment required
- 有更多尺寸选择 Expanded size offering
- 更多样式选择 Enhanced styling
- 耐化学腐蚀的内板 Chemical resistant interior liner



Downdraft Bypass
从通风柜顶部特殊旁通区域补风，流量更大，阻力



Improved Combination Sash
组合移门的特点是顶部悬挂。无框，通过滚珠轴承实现平滑的运转。移门及顶部的边缘减小，这样，内部可视性最佳，干扰最小。珠轴承实现平滑的运转。



Chain & Sprocket Sash Support System
移门平衡系统由铰链和链轮支撑，同时包含限位轴和移门调平系统。

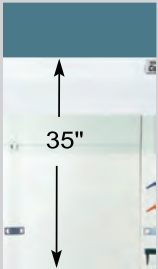

35" High Sightline
移门可视高度有35英寸高，为通风柜内部提供最佳的观测。



Secondary Trough
防护槽提供额外的防护，阻止凹形台面未能防护的溅污。



Low Profile Airfoil
补风翼片的设计符合人体工程学原理，流进通风柜的气流更加平滑顺畅。



Fixed Baffle System
通风柜的扰流板不需要调整。已经在工厂调整到最佳气流位置。

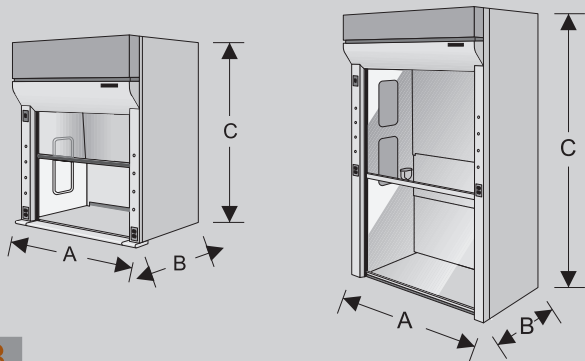

参数 Type	A 长度 Length (mm)	B 深度 Depth (mm)		C 高度 Height (mm)	
台式通风柜 Bench Top Fume Hood	1219	794		1613 vertical sash	
	1524	946		1765 combination sash	
	1828	794	946	1613 vertical sash	1765 combination sash
	2438				
落地式通风柜 Walk-in Fume Hood	1828	794			
	2438	946			
		1098			

通风柜工作原理

Working Principle

通风柜的排气系统有两种类型，一种是恒量式 (CAV - Constant volume), 另一种是变量式 (VAV - Variable airvolume)。

这两种排气模式都可以在多立的通风柜或是带有排气歧管的多个通风柜系统中进行工作。同时，通风柜的排气系统需要与室内空调系统兼容。

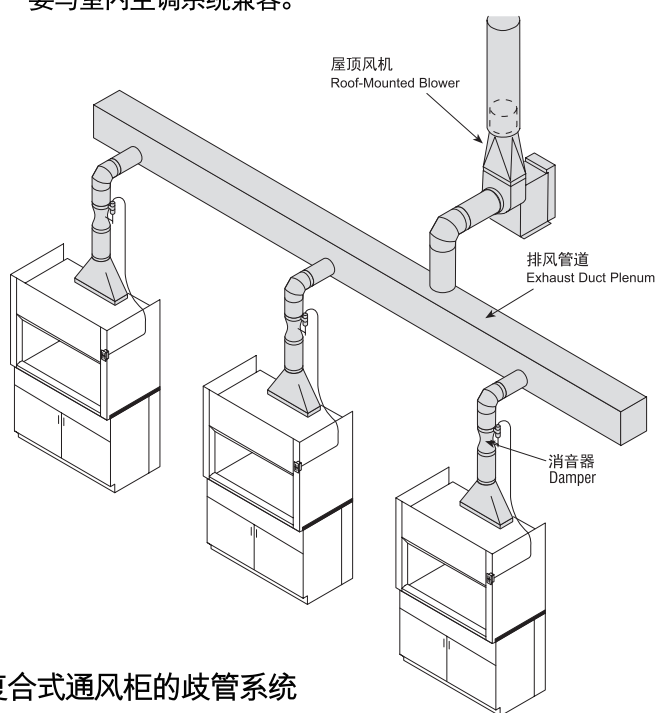

复合式通风柜的歧管系统
HVAC Manifold System

CAV

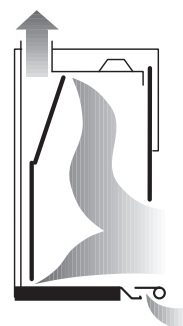

关闭状态

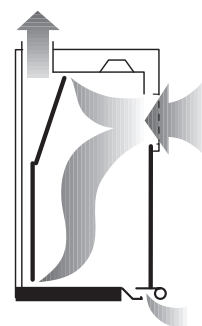

操作状态

VAV

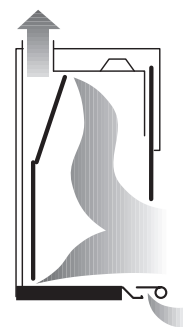

关闭状态

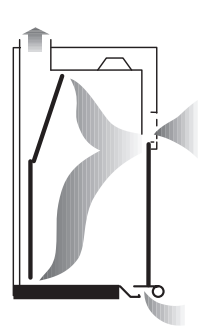

操作状态

限制旁通式变量排气

由于变量阀门的款式和开放大小的可变因素，变量排气模式需要根据不同的风量来调节，以保持表面风速不变。这种限制旁通式的通风柜是专为此而设计。移门开启时，风量最大，在移门关闭时，这种通风柜的补风量很小，可以达到节能的目的，同时保持表面风速不变。



实验室配套设施

Laboratory Accessory

成功的实验室不仅需要先进的仪器设备，合理的实验室家具，同时也需要美观，耐用,安全的实验室专业配件。

A well designed and successful laboratory setup requires complementing accessories. The usage of these accessories will enhance the safety, aesthetic value and work efficiency of the laboratory.

水槽 Sink



环氧树脂水槽
Epoxy Sink



不锈钢水槽
Stainless Steel Sink

滴水架 Pegboard



环氧树脂滴水架
Epoxy Pegboard



PP 滴水架
PP Pegboard



不锈钢滴水架
Steel Pegboard

龙头 Faucet



单口龙头
Single Valve Faucet



纯水水龙头
Distilled Water Faucet



冷热水龙头
Hot/Cold Mixer Faucet



冷热水龙头
Hot/Cold Mixer Faucet



冷热水龙头
Hot/Cold Mixer Faucet



混合水龙头
Combination Faucet

紧急冲淋洗眼器 Emergency Shower And Eyewash



台式洗眼器 Bench Eyewash



气体考克 Gas Outlets



实验室安全柜及气瓶柜

Laboratory Chemicals & Storage Cabinets



易燃物品柜
Flammable Storage Cabinet



易燃物品柜 (内)
Flammable Storage Cabinet



储液罐
Chemical Liquid Storage Tank



强酸碱安全柜
Strong Acid/Base Cabinet



强酸碱安全柜 (内)
Strong Acid/Base Cabinet



腐蚀性化学品储藏柜
Corrosive Chemical Cabinet



气瓶柜
Gas Cylinder Cabinet



气瓶柜 (内)
Gas Cylinder Cabinet



试剂/药品柜
Reagent / Medicine Cabinet

实验室通风系统

Laboratory Ventilation and Air Supply

通风系统是实验室消除化学有害物质及化学气体的关键。为了营造一个安全，有利的工作环境，通风系统必须保持最佳平衡。排进室内的新鲜空气，同时通风系统会制造处负压来除去有害的化学气体。这一通风排气对实验室环境尤为重要。可以针对不同的区域和房间来设计。

Air supply and ventilation system in a laboratory is essential to eliminate harmful elements from chemicals and gasses. To create a safe and conducive working environment, fresh air supply and the ventilation system must closely to create an optimum balancing. Fresh air is supplied into the laboratory while the ventilation system will create a negative pressure in the laboratory environment which will eliminate the harmful chemical vapors and gasses. This balancing of the supply and exhaust creates an air change which is crucial for the laboratory environment. Different areas and rooms can be designed with an optimum air change to meet its function and energy efficiency.

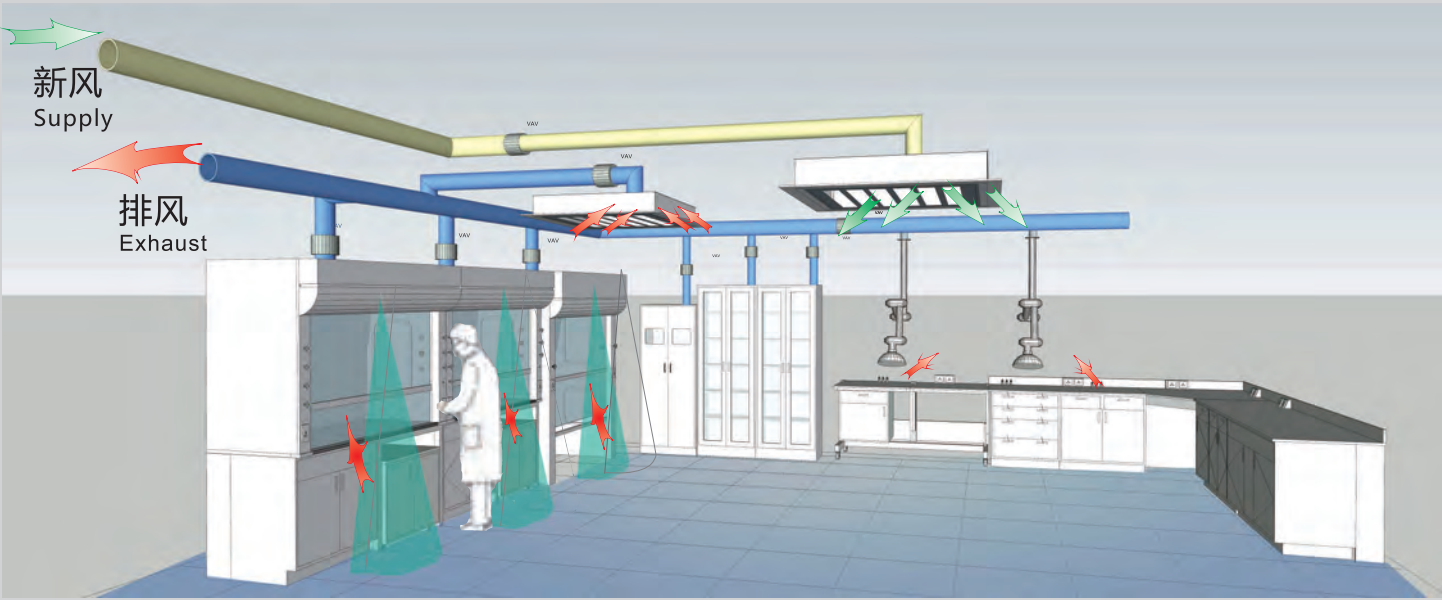

房间通风系统工作示意图
Ventilation System



空调系统细节图
Ventilation System Details

实验室局部排风设计

Localized Extraction

实验室的局部排风可以消除相关设备排放出来的气体。为了增加能源效率，本地抽取可以减少空调系统的负担来降低房间温度。高温发动设备可以放在定制的通风系统下。

Local ventilation can be designed to meet usage conditions which can remove any emission from specific equipment in use. For increased energy efficiencies, localized extraction can also be used to reduce the burden of the air conditioning system to lower the room temperature. High heat generating equipment can be placed under customized ventilation enclosure to achieve this purpose.

万向抽气罩 Fume Exhaust >>>>



<<<<< Atomic Absorption Extractor 原子吸收罩



实验室配气系统

Gas Supply System

配气系统是一项特殊的设施。衡量配气系统的标准是根据它的净化等级和高安全要求。大多数实验室使用的敏感设备通常都对气体供给的纯度相当敏感。配气系统的纯度会减少设备使用的精确和效率。如果纯度不保持的话设备的数据将会受到影响。实验室里多种气体也并不安全，现在大多数实验室都会使用易燃，有毒，易窒息的气体。因次，使用不当的配气系统的成本是不可估量的。为了保证实验室里最高的安全，纯净标准以及美观，所有气体管路的连接采用无缝焊接和最高标准的配件。

The gas supply system is a specialized utility in the laboratory. The main criteria for the gas system are the level of purity and its high safety requirements. Most laboratory uses sensitive equipment which is highly sensitive to the purity of the gas supplied. The purity of the gas system will reduce the accuracy and efficiency of the equipment used. Data obtained from equipment may be compromised if the purity is not maintained. The diversity of the gasses required in laboratories increases hazards of the laboratory. There are often flammable, toxic and asphyxiation gasses used in most of today's laboratory. Therefore, the cost of an improper gas system is unmeasurable. Gas distribution lines are automatic orbital welded and fitted with high standard fittings to ensure highest level of safety, purity and the aesthetic value of an organized laboratory.

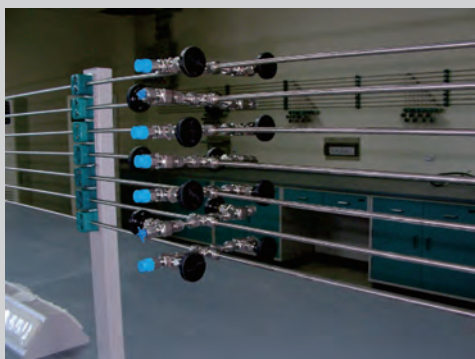

气体管路细节图
Gas Supply System Details

配气系统配件

Gas System Fittings & Accessories



卡套配件
Compression Fittings



焊接配件
Welded Fittings



不锈钢无缝管
Stainless steel seamless tubing



压力表
Pressure gauges



软管
Hose and flexible tubing



球阀
Ball valves



针形阀
Needle valves



拨动开关阀
Toggle valves



快速接头
Quick connects



止回阀
Check valves



阀门执行器
Valve Actuators



阻火器
Flashback arrestor



泄压阀
Pressure relief valves



减压阀
Pressure regulators



隔膜阀
Diaphragm valves



自动转换器
Gas Cylinder Changeover System



实验室洁净室

Cleanroom

洁净室是指一个具有低污染水平的环境，这里所指的污染来源有灰尘，空气传播的微生物，悬浮颗粒，和化学挥发性气体。更准确地说，一个洁净室具有一个受控的污染级别，污染级别可用每立方的颗粒数，或者用最大颗粒大小来确定的。作为生产设施，净室可以占据厂房很多位置。净室被广泛地应用在对环境污染特别敏感的行业，例如半导体生产、生化技术、生物技术、精密机械、制药、医院等行业等。洁净室的外气经由外气空调箱初步过滤微尘，并控制其温湿度后，带动净室的气流循环带走微尘及热量或者经过超高性能过滤网过滤。出入人员需要经过风淋间并且穿着防护装备比如头盔，面罩，手套，防护鞋，工作服。低级别的洁净室只需要防护鞋，并且出入的人员身上不要沾染灰尘及尘土。但是，为了安全考虑，鞋底必须防滑。进入洁净室对服装的要求非常严格。洁净室里的设备排出的气体必须是低污染的。洁净室的家具也必须是容易清洁以及少灰尘颗粒的。大为了避免泄露或者室内空气外流而使得未过滤的气体流入，大多数的洁净室都是控制都是控制在稳定压力。洁净室的HVAC系统用于控制相对湿度。离子发生器是用来防止静电放电问题的出现。HAVC系统是为了确保空气加压系统保持在一个稳定的水平。

Cleanroom is an environment, typically used in scientific research or manufacturing, which has a low level of environmental pollutants such as dust, airborne microbes, aerosol particles and chemical vapors. More accurately, a cleanroom has a controlled level of contamination that is specified by the number of particles per cubic meter at a specified particle size. Cleanrooms can be very large. Entire manufacturing facilities can be contained within a cleanroom with factory floors covering thousands of square meters. They are used extensively in semiconductor manufacturing, biotechnology, the life sciences and other fields that are very sensitive to environmental contamination. The air entering a cleanroom from outside is filtered to exclude dust, and the air inside is constantly recirculated through high-efficiency particulate air (HEPA) and ultra-low penetration air (ULPA) filters to remove internally generated contaminants. Personnel enters and leaves through airlocks with air shower and wear protective clothing such as hoods, face masks, gloves, boots and coveralls. Low-level cleanrooms may only require special shoes, with completely smooth soles that do not track in dust or dirt. However, for safety reasons, shoe soles must not create slipping hazards. Access to a cleanroom is usually restricted to those wearing a cleanroom suit. Equipment inside the cleanroom is designed to generate minimal air contamination. Cleanroom furniture is designed to produce minimum of particles and to be easy to clean. Most cleanrooms are kept at a positive pressure so that if there are any leaks,



air leaks out of the chamber instead of unfiltered air coming in. A cleanroom HVAC system is essential to control the humidity to low levels. Extra equipment such as air ionizers is used to prevent electrostatic discharge (ESD) problems. The HVAC system requires air flow control system to ensure the air pressurization is kept to the required level.



洁净系统配件

Cleanroom Equipment

纯水系统装置 Pure Water Systems>>>>



风淋室
Air Shower



传递窗
Pass Window



生物安全柜
Biological Safety Cabinet



传递窗
Pass Window

实验室家具基本柜体

Commonly Used Cabinet

我们的柜体设计能满足每英尺500磅的承重。这意味着一个3英尺的柜体能承重到1500磅的重量。这个重量负载涵盖了目前所有用于实验室工作台安装的仪器设备。

For example our cabinets are made to handle up to 500lbs per foot run. Which means on a 3 feet cabinet it can take up to 1500 lbs. of weight. This weight load covers all bench mount equipment currently

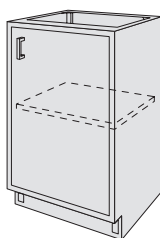
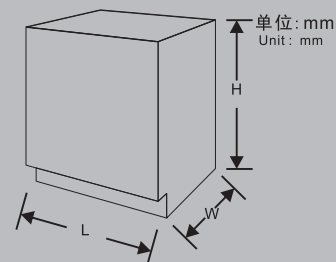

单门底柜
Door Cabinets

编号 Product No.	尺寸 Dimension
102S1320	L381 x W549 x H895
102S2320	L457 x W549 x H895
102S3220	L533 x W549 x H895
102S4220	L610 x W549 x H895

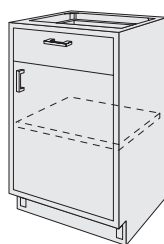

单门单抽底柜
1 Door & 1 Drawer Cabinets

编号 Product No.	尺寸 Dimension
136S1320	L381 x W549 x H890
136S2320	L457 x W549 x H890
136S3320	L533 x W549 x H890
136S4320	L610 x W549 x H890

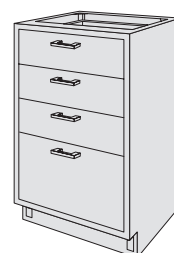

四抽底柜
4 Drawers Cabinets

编号 Product No.	尺寸 Dimension
170S1320	L381 x W549 x H890
170S2320	L457 x W549 x H890
170S3320	L533 x W549 x H890
170S4320	L610 x W549 x H890

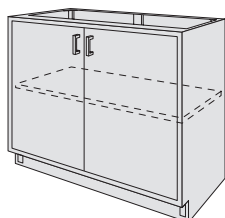

双门底柜
2 Doors Cabinets

编号 Product No.	尺寸 Dimension
106S5320	L762 x W549 x H890
106S6320	L914 x W549 x H890
106S7320	L1067 x W549 x H890
106S8320	L1219 x W549 x H890

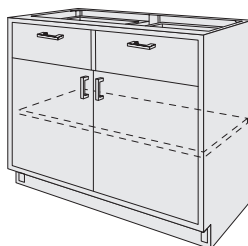

双门双抽底柜
2 Doors & 2 Drawers Cabinets

编号 Product No.	尺寸 Dimension
146S5320	L762 x W549 x H890
146S6320	L914 x W549 x H890
146S7320	L1067 x W549 x H890
146S8320	L1219 x W549 x H890

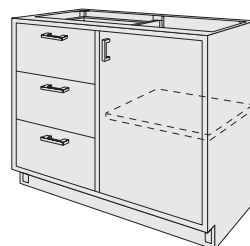

单门三抽底柜
1 Door & 3 Drawers Cabinets

编号 Product No.	尺寸 Dimension
282S5320	L762 x W549 x H890
282S6320	L914 x W549 x H890
282S7320	L1067 x W549 x H890
282S8320	L1067 x W549 x H890

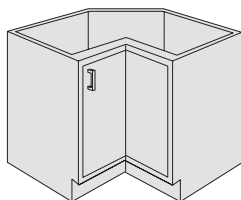

双边转角底柜
Two Sided Corner Cabinets

编号 Product No.	尺寸 Dimension
424S6320	L835 x W549 x H890

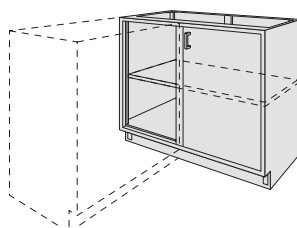

单边转角底柜
Single Corner Cabinets

编号 Product No.	尺寸 Dimension
220S6320	L914 x W549 x H890
220S7320	L1067 x W549 x H890
220S8320	L1219 x W549 x H890

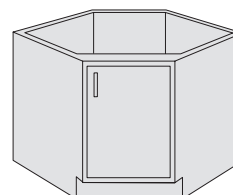

六角转角底柜
Hexagonal Corner Cabinets

编号 Product No.	尺寸 Dimension
422S6320	L835 x W549 x H890

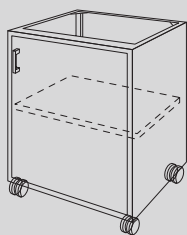

单门移动底柜
Door Mobile Cabinets

编号 Product No. 尺寸 Dimension
950S0800 L457 x W549 x H706
950S0820 L610 x W549 x H706

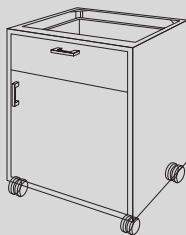

单门单抽移动底柜
1 Door & 1 Drawer Moblie Cabinets

编号 Product No. 尺寸 Dimension
950S085L L457 x W549 x H706
950S086L L610 x W549 x H706

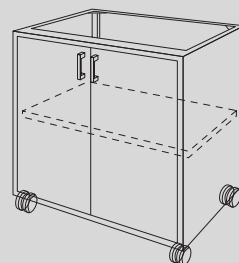

双门移动底柜
2 Doors Moblie Cabinets

编号 Product No. 尺寸 Dimension
950S0840 L762 x W549 x H706

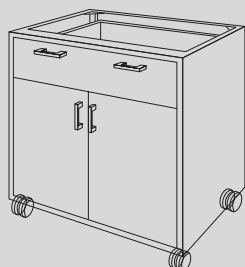

双门双抽移动底柜
2 Doors & 2 Drawers Moblie Cabinets

编号 Product No. 尺寸 Standard
950S089L L762 x W549 x H706

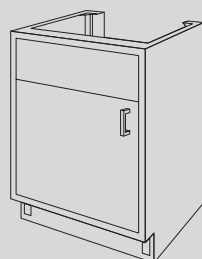

单门水槽底柜
1Door Sink Cabinets

编号 Product No. 尺寸 Standard
112S1320 L381 x W549 x H895
112S2320 L457 x W549 x H895
112S3320 L533 x W549 x H895
112S4320 L610 x W549 x H895

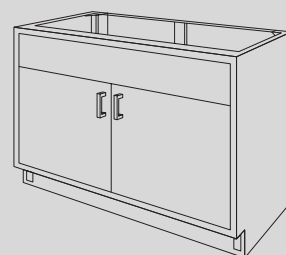

双门水槽底柜
2 Doors Sink Cabinets

编号 Product No. 尺寸 Standard
115S5320 L762 x W549 x H895
115S6320 L914 x W549 x H895
115S7320 L1067 x W549 x H895
115S8320 L1219 x W549 x H895
119S9320 L1524 x W549 x H895

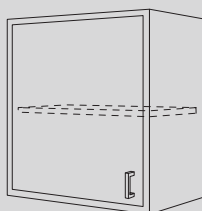

单门吊柜
Solid Swinging 1 Door Cases

编号 Product No. 尺寸 Dimension
702S1230 L381 x W330 x H640
702S2230 L457 x W330 x H640
702S3230 L533 x W330 x H640
702S4230 L610 x W330 x H640

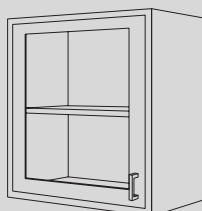

单门玻璃吊柜
Framed Glass Swinging 1Door Cases

编号 Product No. 尺寸 Dimension
708S1230 L381 x W330 x H640
708S2230 L457 x W330 x H640
708S3230 L533 x W330 x H640
708S4230 L610 x W330 x H640

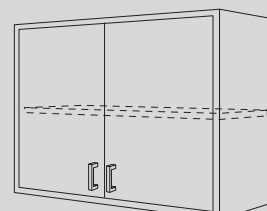

双门吊柜
Solid Swinging 2 Doors Cases

编号 Product No. 尺寸 Dimension
706S5230 L762 x W406 x H640
706S6230 L914 x W406 x H640
706S7230 L1067 x W406 x H640
706S8230 L1219 x W406 x H640

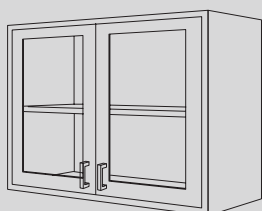

双门玻璃吊柜
Framed Glass Swinging 2 Doors Cases

编号 Product No. 尺寸 Dimension
712S5230 L762 x W406 x H640
712S6230 L914 x W406 x H640
712S7230 L1067 x W406 x H640
712S8230 L1219 x W406 x H640

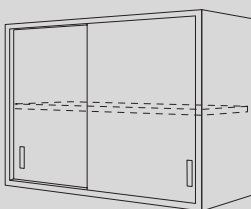

推拉门吊柜
Solid Sliding Door Cases

编号 Product No. 尺寸 Dimension
715S523M L762 x W406 x H640
715S623M L914 x W406 x H640
715S723M L1067 x W406 x H640
715S823M L1219 x W406 x H640

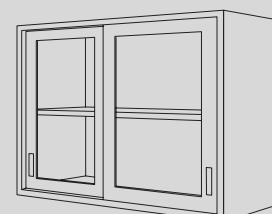

玻璃推拉门吊柜
Framed Glass Sliding Door Cases

编号 Product No. 尺寸 Dimension
718S523M L762 x W406 x H640
715S623M L914 x W406 x H640
715S723M L1067 x W406 x H640
715S823M L1219 x W406 x H640

实验室家具基本柜体

Commonly Used Cabinet

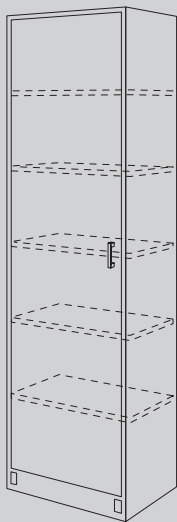

单门高柜
Solid Swinging 1 Door Cases

编号	Product No.	尺寸	Dimension
802S2990		L457 x W483 x H2149	
802S4990		L610 x W483 x H2149	

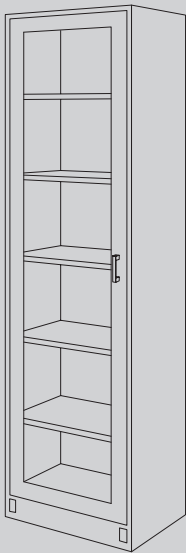

单门玻璃高柜
Framed Glass Swing 1 Door Cases

编号	Product No.	尺寸	Dimension
808S2990		L457 x W483 x H2149	
808S4990		L610 x W483 x H2149	

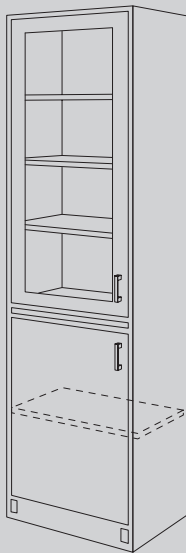

单门混合高柜
Solid &Framed Glass Swing 1 Door Cases

编号	Product No.	尺寸	Dimension
844S4960		L610 x W406 x H2149	

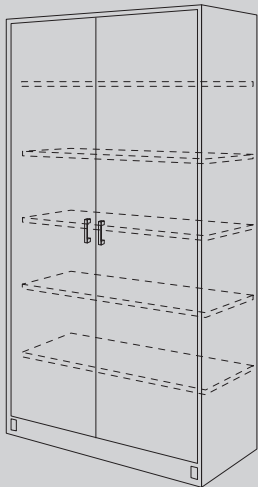

双门高柜
Solid Swinging 2 Doors Cases

编号	Product No.	尺寸	Dimension
806S5990		L762 x W483 x H2149	
806S6990		L914 x W483 x H2149	
806S7990		L1067 x W483 x H2149	
806S8990		L1219 x W483 x H2149	



双门玻璃高柜
Framed Glass Swing 2 Doors Cases

编号	Product No.	尺寸	Dimension
812S5990		L762 x W483 x H2149	
812S6990		L914 x W483 x H2149	
812S7990		L1067 x W483 x H2149	
812S8990		L1219 x W483 x H2149	

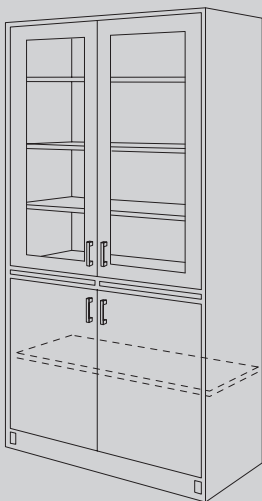

单门混合高柜
Solid &Framed Glass Swing 2 Doors Cases

编号	Product No.	尺寸	Dimension
848S5960		L762 x W406 x H2149	
848S6960		L914 x W406 x H2149	
848S7960		L1067 x W406 x H2149	
848S8960		L1219x W406 x H2149	

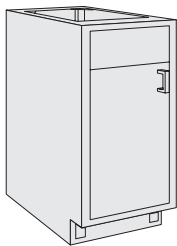

单门通风柜底柜
Fume Hood 1Door Cabinets

编号 Product No.	尺寸 Dimension
122S0320	L305 x W549 x H890
122S4220	L610 x W549 x H890

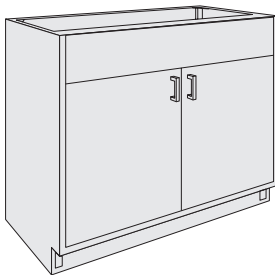

双门通风柜底柜
Fume Hood 2 Doors Cabinets

编号 Product No.	尺寸 Dimension
121S5320	L762 x W549 x H890
121S6220	L914 x W549 x H890
121S7220	L1067 x W549 x H890
121S8220	L1219 x W549 x H890

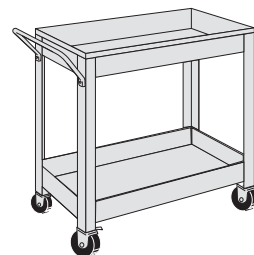

移动车
Mobile Lab Cart

编号 Product No.	尺寸 Dimension
956C2220	L838 x W432 x H813
124S1220	L381 x W549 x H890
124S1220	L381 x W549 x H890



带抽屉的天平台
Drawer Balance Table

编号 Product No.	尺寸 Dimension
957S1170	L914 x W610 x H762
957S1180	L1219 x W610 x H762
957S1190	L1524 x W610 x H762
957S1200	L1829 x W610 x H762

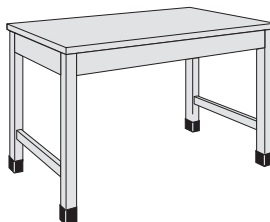

天平台
Balance Tables

编号 Product No.	尺寸 Dimension
957S1090	L914 x W610 x H762
957S1100	L1219 x W610 x H762
957S1110	L1524 x W610 x H762
957S1120	L1829 x W610 x H762

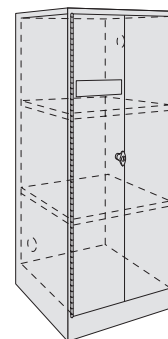

防火高柜
Flammable Liquid Storage Cases

编号 Product No.	尺寸 Dimension
950S8400	L1067 x W549 x H1651

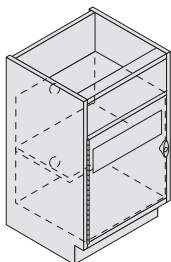

单门防火底柜
1 Door Flammable Liquid Storage Cabinets

编号 Product No.	尺寸 Dimension
950S7760	L610 x W549 x H895

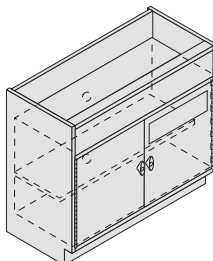

双门防火底柜
2 Doors Flammable Liquid Storage Cabinets

编号 Product No.	尺寸 Dimension
950S7780	L762 x W549 x H895
950S7790	L914 x W549 x H895
950S7800	L1061 x W549 x H895
950S7810	L1219 x W549 x H895

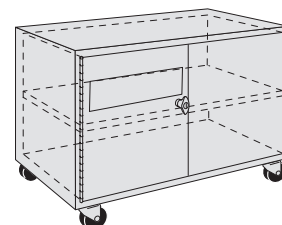

移动防火柜
Flammable Liquid Storage
Mobile Cabinets

编号 Product No.	尺寸 Dimension
950S7900	L864 x W549 x H743

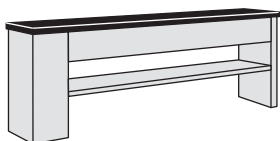

双层普通试剂架
Double Layer Reagent Racks

编号 Product No.	尺寸 Dimension
24L4820	L1219 x W305 x H603
24L4020	L1524 x W305 x H890
24L4220	L1829 x W305x H890



单层普通试剂架
Single Layer Reagent Racks

编号 Product No.	尺寸 Dimension
24L8820	L1219 x W305 x H603
24L8020	L1524 x W305 x H603
24L8220	L1829 x W305x H603

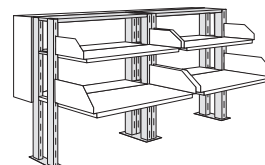

可拓展剂架
Reagent Aprons

编号 Product No.	尺寸 Dimension
24L23800	L965
24L23800	L1270
24L23800	L1575
24L23800	L1676

芮徕（上海）实验仪器有限公司

地址：上海市黄浦区淮海中路333号瑞安广场1206

电话：+86 (21) 5116-0567

传真：+86 (21) 5116-0567

邮编：200020

网址：www.covilla.com

COVILLA TECHNOLOGY CO., LTD.

Add: No. 333 Huaihai Middle Road, Shui On Plaza 1206-A12,
Huangpu District, Shanghai 200021, China

Tel: +86 (21) 5116-0567

Fax: +86 (21) 5116-0567

Website: www.covilla.com

INTERNATIONAL
CERTIFICATION
ISO 9001

